



2 Bedroom Apartment **£135,000**

Bache House, 6 Frankel Avenue, Swindon, SN25 2GY

mcfarlane
property.com

2 Bedroom Apartment North Swindon

- Top floor apartment
 - Two double bedrooms
 - Secure door entry system
 - Allocated parking space
-

TWO DOUBLE BEDROOMS - FANTASTIC
FIRST TIME BUY / INVESTMENT - TOP
FLOOR - POPULAR LOCATION -
ALLOCATED PARKING - MUST BE VIEWED

This is a fantastic two double bedroom, top floor apartment in the popular location of Redhouse, North Swindon. The property has spacious accommodation throughout and briefly comprises; two double bedrooms, an open plan fitted kitchen / living room, a family bathroom suite and large hallway complete with fitted storage. Further benefits include parking, electric storage heaters and integrated kitchen units. Ideal first time buy or investment opportunity.

Leasehold (108 Years remaining)
Ground rent £237 p.a. escalating by RPI every
5 years
Council Tax Band Band C
Council Tax Estimate £1,954





Fourth Floor

Approx. 64.1 sq. metres (689.8 sq. feet)

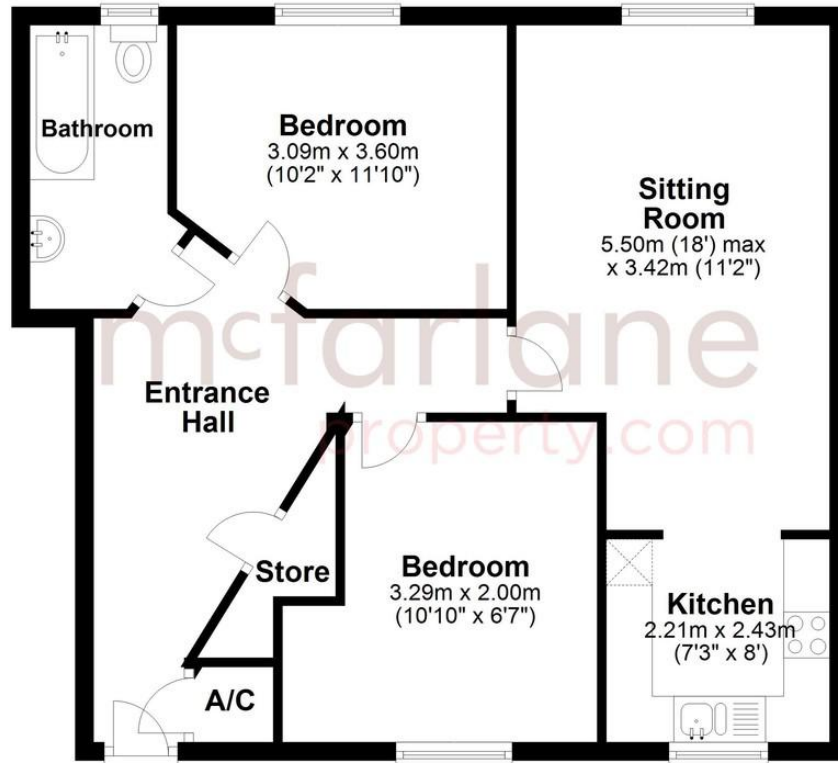

Total area: approx. 64.1 sq. metres (689.8 sq. feet)

We 
where you
LIVE

Our team are friendly, experienced and are all local. They know it better than they do their own living rooms and can help you find what you're looking for because **we love where we live.**

We would be delighted to show you around this property.

**Because every home
needs a personal touch.**

**If you would like to view this
property then please get in touch.**

📞 01793 296600

✉ swindon@mcfarlaneproperty.com

mcfarlaneproperty.com

mcfarlane
property.com

Cricklade.

102 High Street
Cricklade SN6 6AA

📞 01793 751044

Marlborough.

106 High Street
Marlborough SN8 1LT

📞 01672 514380

Old Town.

28-30 Wood Street
Swindon SN1 4AB

📞 01793 296880

Swindon.

The Village Centre,
Redhouse SN25 2FW

📞 01793 296600

Agents Note: Whilst every care has been taken to prepare these sales particulars, they are for guidance purposes only. All measurements are approximate and are for general guidance purposes only and whilst every care has been taken to ensure their accuracy, they should not be relied upon and potential buyers are advised to recheck the measurements