



3 Bedrooms Mid Terraced House £205,000

29 Wootton Bassett Road, Swindon, SN1 4NQ

mcfarlane
property.com

3 Bedrooms Mid Terraced House Swindon, Swindon Town Centre

- Victorian Terraced Property
- Two Reception Rooms
- Three Bedrooms
- Off Road Parking
- Close to Train Station
- Close to M4 Junction 16

A delightful Victorian townhouse ideally located just a short walk into Swindon Town Centre and the Train Station with junction 16 of the M4 just a short drive away. Accommodation briefly comprises of two reception rooms, fitted kitchen, family bathroom and three bedrooms together with a generous rear garden and off road parking for up to three vehicles.









Ground Floor

Approx. 50.4 sq. metres (542.1 sq. feet)

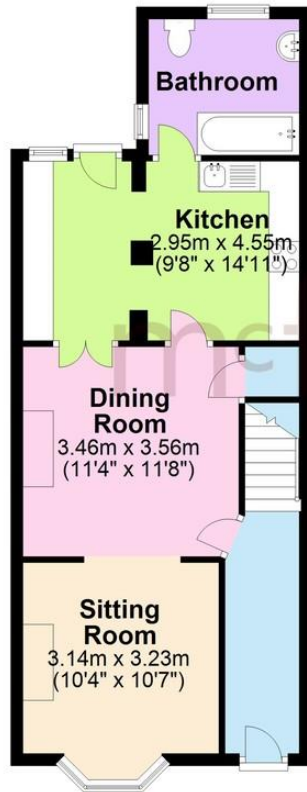

First Floor

Approx. 37.2 sq. metres (400.7 sq. feet)



Total area: approx. 87.6 sq. metres (942.8 sq. feet)

We 
where you
LIVE

Our team are friendly, experienced and are all local. They know it better than they do their own living rooms and can help you find what you're looking for because **we love where we live.**

We would be delighted to show you around this property.

**Because every home
needs a personal touch.**

**If you would like to view this
property then please get in touch.**

 01793 296880

 oldtown@mcfarlaneproperty.com

mcfarlaneproperty.com

mcfarlane
property.com

Cricklade.

102 High Street
Cricklade SN6 6AA

 01793 751044

Marlborough.

106 High Street
Marlborough SN8 1LT

 01672 514380

Old Town.

28-30 Wood Street
Swindon SN1 4AB

 01793 296880

Swindon.

The Village Centre,
Redhouse SN25 2FW

 01793 296600

Agents Note: Whilst every care has been taken to prepare these sales particulars, they are for guidance purposes only. All measurements are approximate are for general guidance purposes only and whilst every care has been taken to ensure their accuracy, they should not be relied upon and potential buyers are advised to recheck the measurements