



Studio Apartment

Marlborough Court, Royal Wootton Bassett, Wiltshire, SN4 8HG

Offers in Excess Of £95,000

mcfarlane
property.com

Studio Apartment

Royal Wootton Bassett, Wiltshire

-
- FIRST FLOOR STUDIO APARTMENT
 - IDEAL INVESTMENT
 - WELL PRESENTED THROUGHOUT
-

- FIRST FLOOR STUDIO APARTMENT - EXCELLENT INVESTMENT - CLOSE TO ALL AMENITIES - ALLOCATED PARKING - CALL TO VIEW -

A well presented first floor studio apartment with great access to commuter routes and all local amenities. The open plan studio accommodation provides excellent living at an affordable lifestyle. The accommodation includes a lounge/bedroom, fully fitted kitchen and separate bathroom. Further benefits include double glazing, allocated parking and secure entrance to the main building. Viewing Essential.





m^cfarlane
property.com



Score	Energy rating	Current	Potential
92+	A		
81-91	B		82 B
69-80	C	69 c	
55-68	D		
39-54	E		
21-38	F		
1-20	G		

First Floor

Approx. 30.1 sq. metres (323.8 sq. feet)

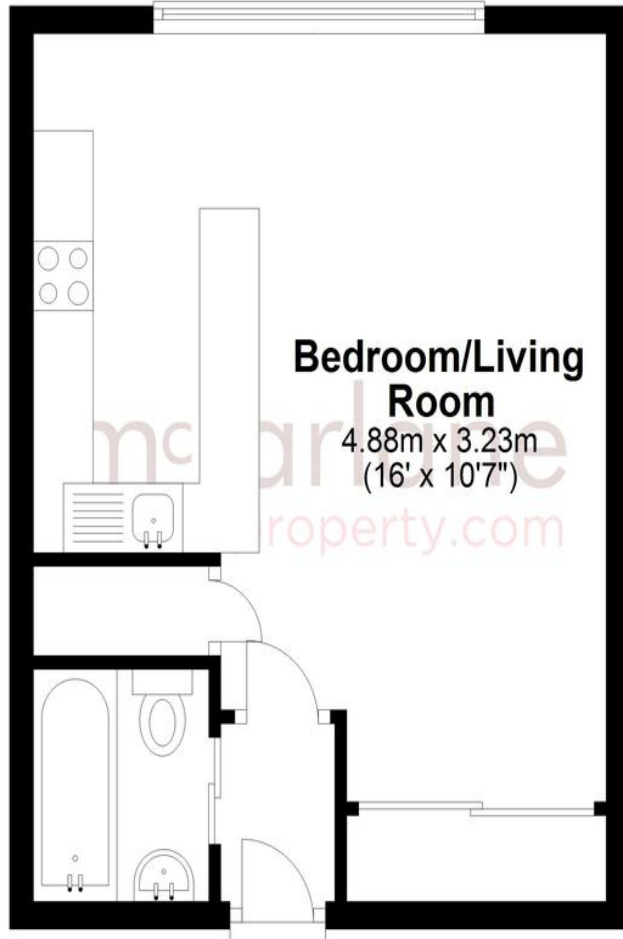

Bedroom/Living Room
4.88m x 3.23m
(16' x 10'7")

Total area: approx. 30.1 sq. metres (323.8 sq. feet)

We 
where you
LIVE

Our team are friendly, experienced and are all local. They know it better than they do their own living rooms and can help you find what you're looking for because **we love where we live.**

We would be delighted to show you around this property.

Because every home needs a personal touch.

If you would like to view this property then please get in touch.

📞 01793 751044

✉ cricklade@mcfarlaneproperty.com

mcfarlaneproperty.com

mcfarlane
property.com

Cricklade.

102 High Street
Cricklade SN6 6AA

📞 01793 751044

Marlborough.

106 High Street
Marlborough SN8 1LT

📞 01672 514380

Old Town.

28-30 Wood Street
Swindon SN1 4AB

📞 01793 296880

Swindon.

The Village Centre,
Redhouse SN25 2FW

📞 01793 296600

Agents Note: Whilst every care has been taken to prepare these sales particulars, they are for guidance purposes only. All measurements are approximate are for general guidance purposes only and whilst every care has been taken to ensure their accuracy, they should not be relied upon and potential buyers are advised to recheck the measurements