



3 Bedrooms Terraced Cottage Guide Price £350,000

2 Spital Lane, Cricklade, Swindon, SN6 6BQ

mcfarlane
property.com

3 Bedrooms Terraced Cottage

Swindon, Cricklade

- Three Bedroom Period Cottage
- Overlooking Neighbouring Countryside
- Period Features & Charm

An improved period cottage in Cricklade and ideally placed for the towns amenities plus views over neighbouring Countryside. The deceptive accommodation is much larger than first impressions would have you believe. This cottage retains many period features and boasts a red brick fire breast with inset wood burner. This well presented cottage offers the following brief summary of accommodation: Entrance Porch, Living Room (6.10M X 5.20M) Kitchen Dining Room (5.10M X 3.65M), First Floor Landing, Three Well Proportioned Bedrooms and Feature Bathroom. Landscaped Gardens and Off Road Parking. uPVC Double Glazing and Gas Fired Central Heating (New Boiler). Sole Selling Agents McFarlane Cricklade 01793 751 044.

Property description





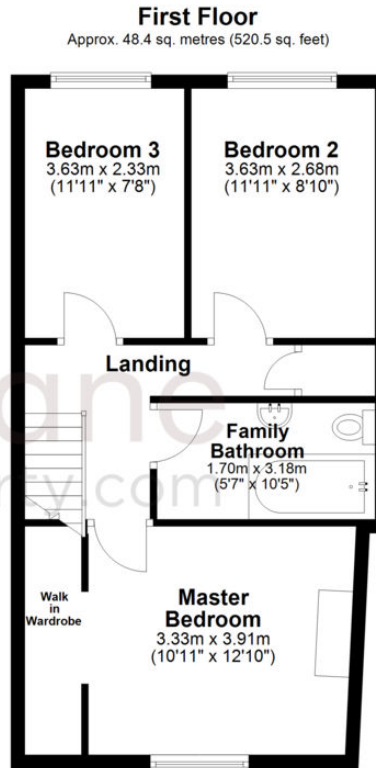
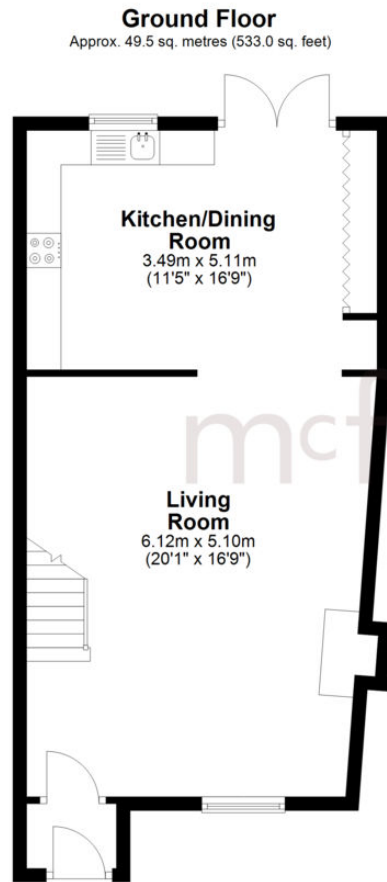

Total area: approx. 97.9 sq. metres (1053.5 sq. feet)

We 
where you
LIVE

Our team are friendly, experienced and are all local. They know it better than they do their own living rooms and can help you find what you're looking for because **we love where we live.**

We would be delighted to show you around this property.

Because every home needs a personal touch.

If you would like to view this property then please get in touch.

📞 01793 751044

✉ cricklade@mcfarlaneproperty.com

mcfarlaneproperty.com

mcfarlane
property.com

Cricklade.
102 High Street
Cricklade SN6 6AA
📞 01793 751044

Marlborough.
106 High Street
Marlborough SN8 1LT
📞 01672 514380

Old Town.
28-30 Wood Street
Swindon SN1 4AB
📞 01793 296880

Swindon.
The Village Centre,
Redhouse SN25 2FW
📞 01793 296600

Agents Note: Whilst every care has been taken to prepare these sales particulars, they are for guidance purposes only. All measurements are approximate are for general guidance purposes only and whilst every care has been taken to ensure their accuracy, they should not be relied upon and potential buyers are advised to recheck the measurements