



mcfarlane
property.com



3 Bedroom Mid Terraced House **£265,000**

27 Lyndhurst Crescent, Swindon, SN3 2RW

mcfarlane
property.com

3 Bedroom Mid Terraced House Swindon, Swindon East, SN3

- THREE BEDROOMS
- MODERN KITCHEN & BATHROOM
- TWO RECEPTION ROOMS
- FRONT & REAR GARDENS
- GAS CENTRAL HEATING
- EXTENDED TO THE REAR



Property description

McFarlane Sales & Lettings are delighted to welcome to market this beautifully presented three-bedroom mid terraced home which has been modernised throughout. The property comprises a welcoming entrance hall, utility room, a modern fitted kitchen with access to the rear garden and a large living room leading through to the snug. On the first floor, there are two double bedrooms with one providing built in storage. There is a further single bedroom and newly fitted shower suite. The property benefits from ample parking for the area, to the rear of the property there is a generous garden mainly laid with lawn and a patio area. Situated in Park North this property provides easy access to Swindon town center the Great Western Hospital, A419 and Junction 16.



We where you LIVE

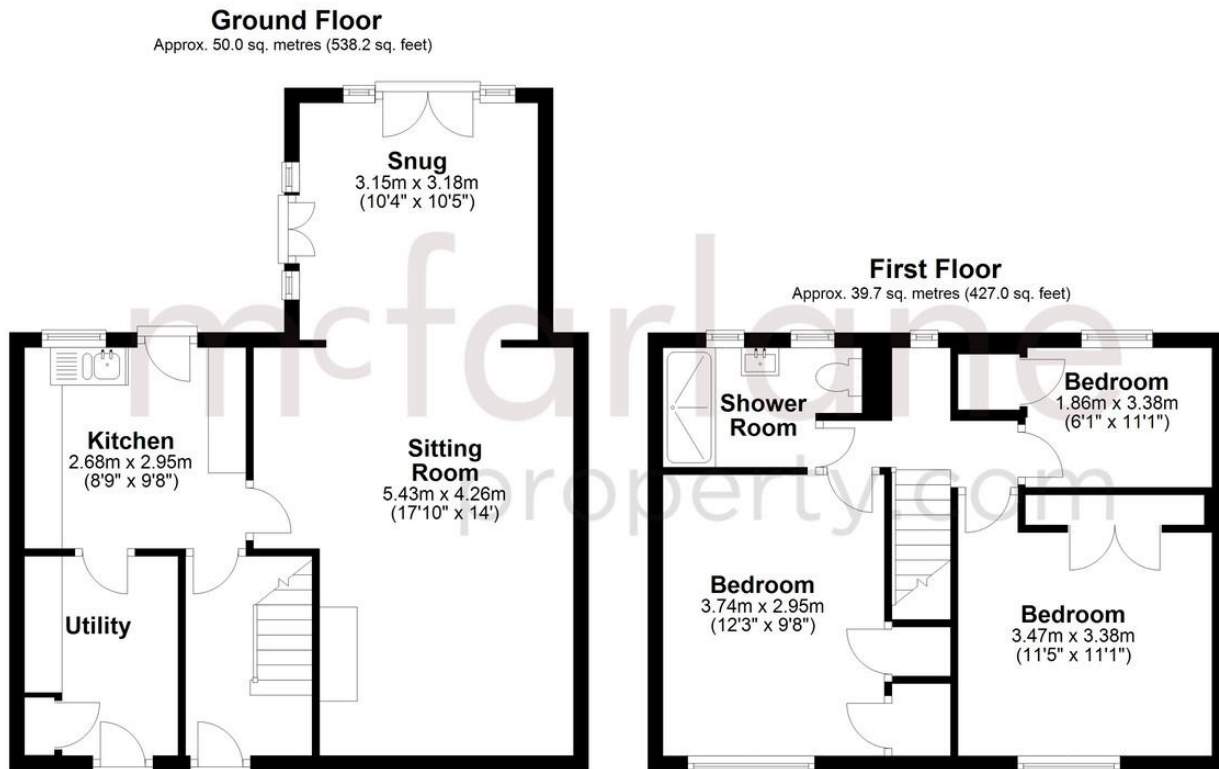

Total area: approx. 89.7 sq. metres (965.1 sq. feet)

Our team are friendly, experienced and are all local. They know it better than they do their own living rooms and can help you find what you're looking for because **we love where we live.**

We would be delighted to show you around this property.

Because every home needs a personal touch.

If you would like to view this property then please get in touch.

📞 01793 296880

✉ oldtown@mcfarlaneproperty.com

mcfarlaneproperty.com

mcfarlane
property.com

Cricklade.
102 High Street
Cricklade SN6 6AA
📞 01793 751044

Marlborough.
106 High Street
Marlborough SN8 1LT
📞 01672 514380

Old Town.
28-30 Wood Street
Swindon SN1 4AB
📞 01793 296880

Swindon.
The Village Centre,
Redhouse SN25 2FW
📞 01793 296600

Agents Note: Whilst every care has been taken to prepare these sales particulars, they are for guidance purposes only. All measurements are approximate are for general guidance purposes only and whilst every care has been taken to ensure their accuracy, they should not be relied upon and potential buyers are advised to recheck the measurements