



4 Bedroom Detached House **£425,000**

Clary Road, Swindon, Wiltshire, SN2 2ST

mcfarlane
property.com

4 Bedroom Detached House North Swindon

- DETACHED EXTENDED FAMILY HOME
- 8 SOLAR PANELS
- IMPRESSIVE MODERN FITTED KITCHEN
- CONSERVATORY

A STUNNINGLY PRESENTED and EXTENDED family home. With a magnificent MODERN FITTED KITCHEN including an ISLAND with induction hob and extractor plus integrated appliances. The ground floor also benefits from a dining room, living room, CONSERVATORY with UNDERFLOOR HEATING and cloakroom. On the first floor there are 4 bedrooms all with built in storage, a SHOWER ROOM to the master and a family bathroom. The rear garden is larger than average and to the front of the property there is an EXTENSIVE DRIVEWAY PARKING and SINGLE GARAGE. The property also benefits from 8 SOLAR PANELS that for the current owners, keeps the house fully supplied with hot water.

Council Tax Band D

Council Tax Estimate £2,198





We where you LIVE

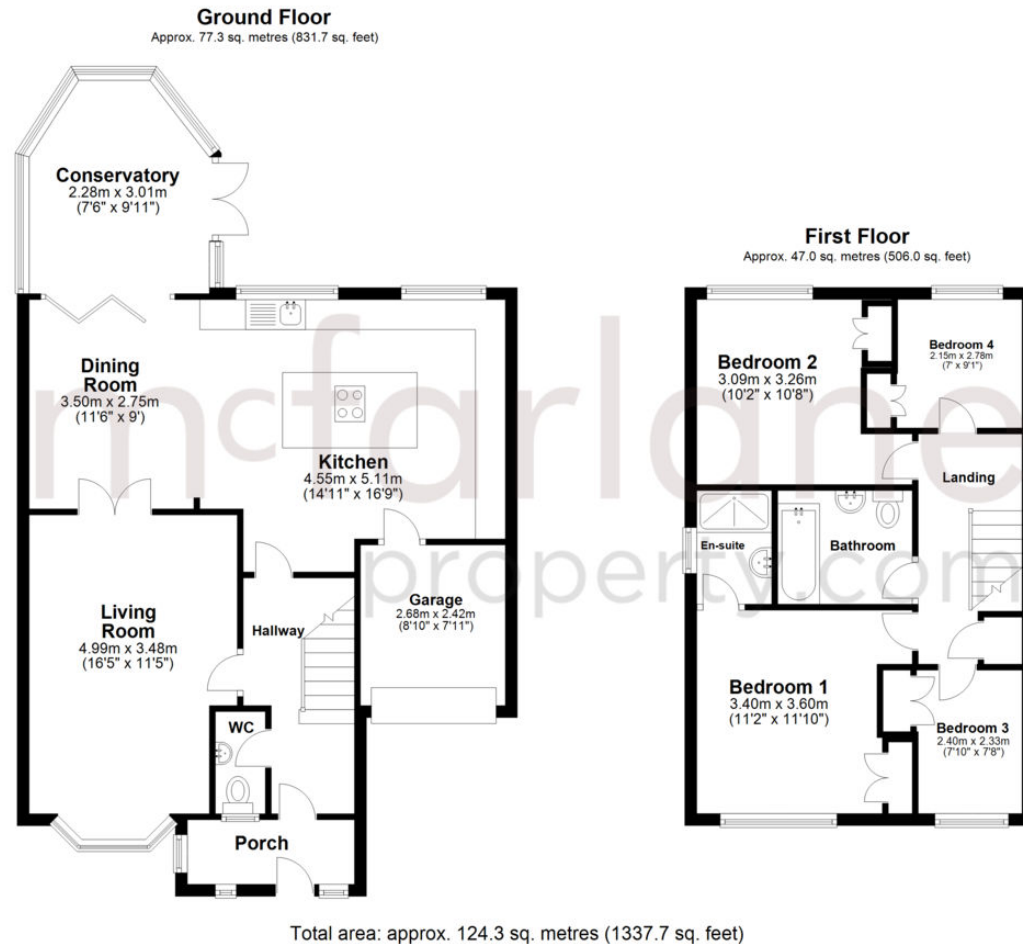

Our team are friendly, experienced and are all local. They know it better than they do their own living rooms and can help you find what you're looking for because **we love where we live.**

We would be delighted to show you around this property.

Because every home needs a personal touch.

If you would like to view this property then please get in touch.

☎ 01793 296600

✉ swindon@mcfarlaneproperty.com

mcfarlaneproperty.com

mcfarlane
property.com

Cricklade.
102 High Street
Cricklade SN6 6AA
☎ 01793 751044

Marlborough.
106 High Street
Marlborough SN8 1LT
☎ 01672 514380

Old Town.
28-30 Wood Street
Swindon SN1 4AB
☎ 01793 296880

Swindon.
The Village Centre,
Redhouse SN25 2FW
☎ 01793 296600

Agents Note: Whilst every care has been taken to prepare these sales particulars, they are for guidance purposes only. All measurements are approximate are for general guidance purposes only and whilst every care has been taken to ensure their accuracy, they should not be relied upon and potential buyers are advised to recheck the measurements