



mcfarlane  
property.com



2 Bedroom Terraced House £210,000

23 Drew Street, Swindon, SN2 2HP

mcfarlane  
property.com

## 2 Bedroom Terraced House Swindon, Rodbourne

---

- IDEAL FIRST TIME OR INVESTMENT BUY
  - TWO RECEPTION ROOMS
  - TWO DOUBLE BEDROOMS
  - FITTED KITCHEN
  - FULLY ENCLOSED GARDEN
  - WELL PRESENTED THROUGHOUT
- 



An ideal first time or investment purchase is this well presented two bedroom property located just a short walk from local amenities and transport links. Accommodation briefly comprises sitting room with open fireplace, dining room, fitted kitchen, bathroom, two double bedrooms and rear garden.



### Property description

A well presented bay fronted home ideally situated in the popular Rodbourne area with excellent transport links and just a short walk from local amenities.

A useful porch provides access to the ground floor with hallway, sitting room with bay window to front and attractive open fireplace, dining room, fitted kitchen, inner hall with door to rear and newly fitted three piece bathroom.

To the first floor are two double bedrooms.

Further benefits include original feature fireplaces, wood flooring, gas central heating, recently fitted gas boiler, rear access and close to Rodbournes many amenities including an Aldi supermarket, McArthurGlen Outlet Centre, bus routes and Swindon mainline railway station.



### Ground Floor

Approx. 42.8 sq. metres (460.5 sq. feet)

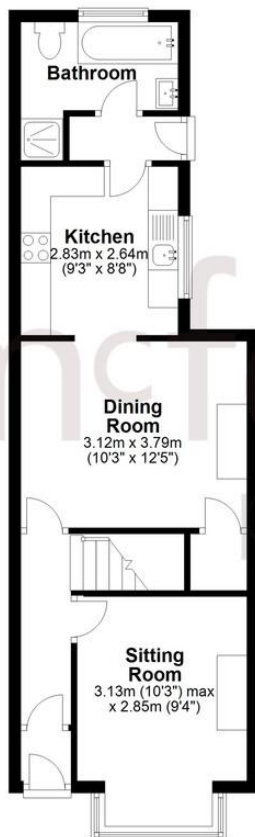

### First Floor

Approx. 27.3 sq. metres (293.8 sq. feet)



Total area: approx. 70.1 sq. metres (754.3 sq. feet)

We   
where you  
**LIVE**

Our team are friendly, experienced and are all local. They know it better than they do their own living rooms and can help you find what you're looking for because **we love where we live.**

We would be delighted to show you around this property.

**Because every home  
needs a personal touch.**

**If you would like to view this  
property then please get in touch.**

 01793 296880

 [oldtown@mcfarlaneproperty.com](mailto:oldtown@mcfarlaneproperty.com)

[mcfarlaneproperty.com](http://mcfarlaneproperty.com)

**mcfarlane**  
property.com

#### **Cricklade.**

102 High Street  
Cricklade SN6 6AA

 01793 751044

#### **Marlborough.**

106 High Street  
Marlborough SN8 1LT

 01672 514380

#### **Old Town.**

28-30 Wood Street  
Swindon SN1 4AB

 01793 296880

#### **Swindon.**

The Village Centre,  
Redhouse SN25 2FW

 01793 296600

Agents Note: Whilst every care has been taken to prepare these sales particulars, they are for guidance purposes only. All measurements are approximate are for general guidance purposes only and whilst every care has been taken to ensure their accuracy, they should not be relied upon and potential buyers are advised to recheck the measurements