



4 Bedroom Detached House £400,000

Magdalene Close, South Marston, Swindon, Wiltshire, SN3 4FR

**mcfarlane**  
property.com

## 4 Bedroom Detached House South Marston

- 
- Detached House
  - Four Bedrooms
  - Large modern Kitchen Dining Room
- 

This lovely DETACHED home, in SHOW HOME condition is situated in South Marston. With a stunning MODERN KITCHEN and dining room as well as a BEAUTIFULLY PRESENTED living room. With FOUR good sized BEDROOMS, with an EN-SUITE to the master as well as family bathroom and a SINGLE GARAGE and driveway parking, this is a perfect family home.





## Property description

### ENTRANCE HALL

Accessed through the front door under the covered porch the entrance hall provides access to the living room, kitchen dining room, WC and the stairs to the first floor as well as a handy storage cupboard.

### LIVING ROOM

Situated at the front of the property this lovely living room has ample space for all the family and is beautifully presented by the current owners.

### KITCHEN DINING ROOM

To the rear of the property the kitchen dining room is a lovely space with a window and French doors to the garden. The kitchen is fitted with a range of handle less base and wall units and benefits from an island unit with a breakfast bar. There is also an integrated fridge freezer, an eye level double oven, gas hob with an extractor over as well as a stainless-steel sink and drainer situated under the window, the perfect view when doing the dishes. The whole kitchen is complemented by the range of down lights as well as additional integrated appliances. From the dining area there is also a useful under stairs cupboard.

### WC

With a wash hand basin, WC with a window to the front of the property.



#### LANDING

Providing access to all the bedrooms as well as the family bathroom and a useful storage cupboard.

#### BEDROOM 1

Located to the rear of the property this lovely master bedroom has ample space for a double bed as well as additional storage. There is a door to the en-suite.

#### EN-SUITE

With stylish wall tiles and a walk in shower with glass panel, wash hand basin, heated towel rail and WC.

#### BEDROOM 2

Also situated to the rear of the property this is a great sized double bedroom.

#### BEDROOM 3

To the front of the property a further double bedroom.

#### BEDROOM 4

With a window to the front of the property this is a great single bedroom that would also be a perfect home office, dressing room or nursery.

#### FAMILY BATHROOM

Stylishly decorated the family bathroom has a panel bath with shower over and glass shower screen, wash hand basin and WC





## EXTERNAL

To the front of the property there is a path to the front door that also leads to the driveway parking and the single garage.

To the rear of the property there is a simple but stylish garden ready for you to add your own personality. Currently laid out with a patio perfect for outdoor eating and BBQs. There is also a lawn and a pedestrian door to the garage.



## Ground Floor

Approx. 54.0 sq. metres (581.7 sq. feet)

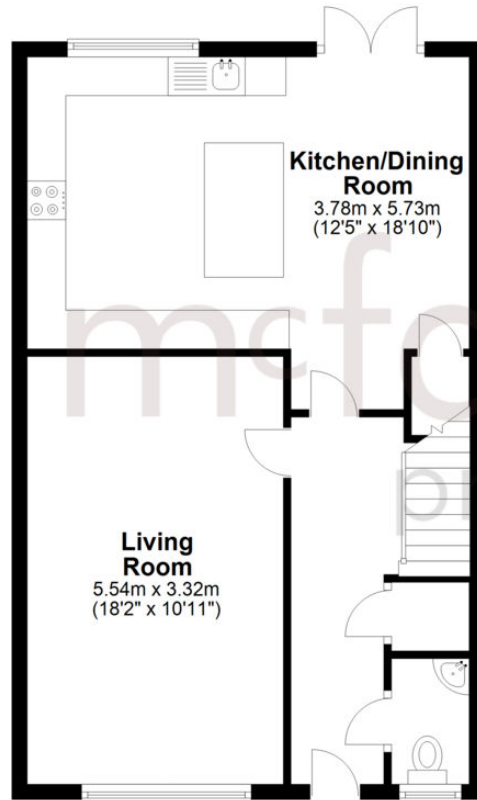

## First Floor

Approx. 53.5 sq. metres (576.2 sq. feet)

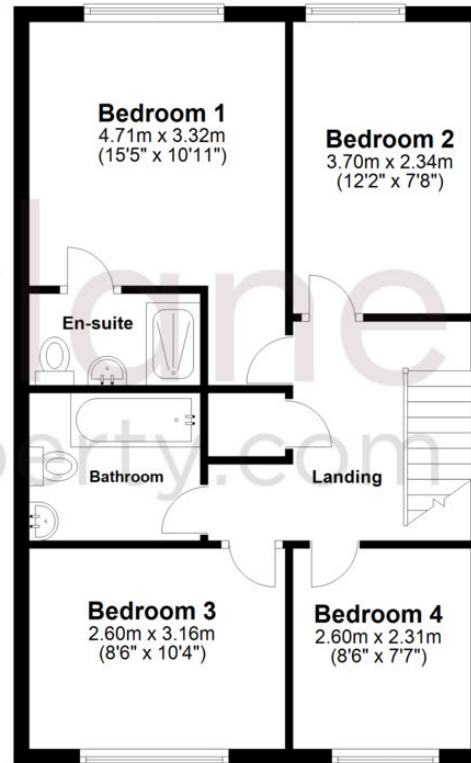

Total area: approx. 107.6 sq. metres (1157.9 sq. feet)

We   
where you  
**LIVE**

Our team are friendly, experienced and are all local. They know it better than they do their own living rooms and can help you find what you're looking for because **we love where we live.**

We would be delighted to show you around this property.

**Because every home  
needs a personal touch.**

**If you would like to view this  
property then please get in touch.**

 01793 296600

 [swindon@mcfarlaneproperty.com](mailto:swindon@mcfarlaneproperty.com)

[mcfarlaneproperty.com](http://mcfarlaneproperty.com)

**mcfarlane**  
property.com

### **Cricklade.**

102 High Street  
Cricklade SN6 6AA

 01793 751044

### **Marlborough.**

106 High Street  
Marlborough SN8 1LT

 01672 514380

### **Old Town.**

28-30 Wood Street  
Swindon SN1 4AB

 01793 296880

### **Swindon.**

The Village Centre,  
Redhouse SN25 2FW

 01793 296600

Agents Note: Whilst every care has been taken to prepare these sales particulars, they are for guidance purposes only. All measurements are approximate are for general guidance purposes only and whilst every care has been taken to ensure their accuracy, they should not be relied upon and potential buyers are advised to recheck the measurements