



2 Bedroom Apartment **£135,000**

33 Pioneer Road, Oakhurst, Swindon, Wiltshire, SN25 2HZ

mcfarlane
property.com

2 Bedroom Apartment North Swindon

- NO ONWARD CHAIN
 - TWO BEDROOM APARTMENT
 - SPACIOUS LIVING ACCOMODATION
 - BATH WITH SHOWER OVER
-

INVESTORS ONLY! This spacious **TWO DOUBLE BEDROOM** apartment is situated in Oakhurst, North Swindon. The property comprises of a **LARGE LOUNGE/DINER**, separate kitchen, two good sized bedrooms & bathroom with shower. The property also benefits from secure phone entry system, **ALLOCATED PARKING** & Gas Central Heating. To the rear of the property is a **COMMUNAL GRASSED AREA** that is maintained by the Management Company.

Council Tax Band C
Council Tax Estimate £1,954
Property Tenure - Leasehold (104 Years)
Service Charge (£PA) £1,500
Ground Rent (£PA) £150





Ground Floor

Approx. 60.3 sq. metres (649.1 sq. feet)

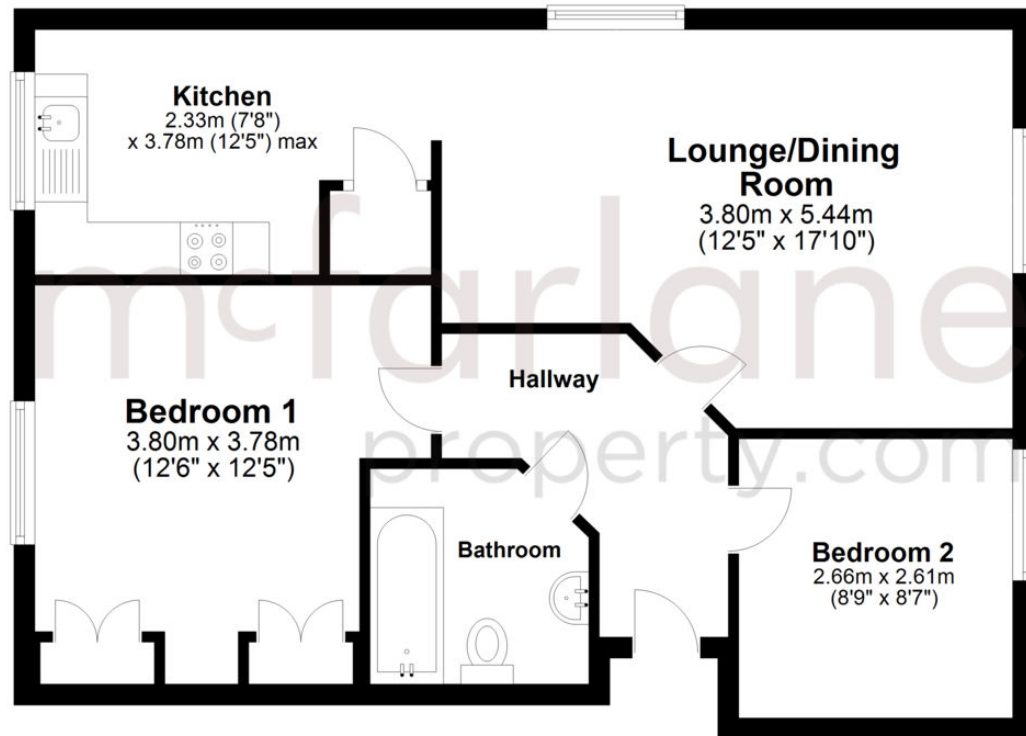

Total area: approx. 60.3 sq. metres (649.1 sq. feet)

We 
where you
LIVE

Our team are friendly, experienced and are all local. They know it better than they do their own living rooms and can help you find what you're looking for because **we love where we live.**

We would be delighted to show you around this property.

**Because every home
needs a personal touch.**

**If you would like to view this
property then please get in touch.**

 01793 296600

 swindon@mcfarlaneproperty.com

mcfarlaneproperty.com

mcfarlane
property.com

Cricklade.

102 High Street
Cricklade SN6 6AA

 01793 751044

Marlborough.

106 High Street
Marlborough SN8 1LT

 01672 514380

Old Town.

28-30 Wood Street
Swindon SN1 4AB

 01793 296880

Swindon.

The Village Centre,
Redhouse SN25 2FW

 01793 296600

Agents Note: Whilst every care has been taken to prepare these sales particulars, they are for guidance purposes only. All measurements are approximate are for general guidance purposes only and whilst every care has been taken to ensure their accuracy, they should not be relied upon and potential buyers are advised to recheck the measurements