



mcfarlane
property.com



1 Bedroom First Floor Apartment £122,500

Savernake Court, Savernake Street, Swindon, SN1 3LX

mcfarlane
property.com

1 Bedroom First Floor Apartment Swindon, Savernake Street, SN1

- FIRST FLOOR APARTMENT
 - DOUBLE BEDROOM
 - FITTED WARDROBE
 - ALLOCATED PARKING
 - TOWN CENTRE LOCATION
 - ***type of** BOILER STILL UNDER WARRANTY
 - RECENTLY FITTED ELECTRICAL CONSUMER UNIT
-



Property description

McFarlane Sales & Lettings are pleased to offer a large one bedroom first floor apartment situated perfectly within walking distance of the Town centre, railway station and Old Town. The property boasts a spacious kitchen, a bathroom and large living room with a beautiful Juliet balcony as well as a spacious double bedroom with built in wardrobes. This property would be a great investment opportunity or first time buy.



Ground Floor

Approx. 40.7 sq. metres (437.7 sq. feet)

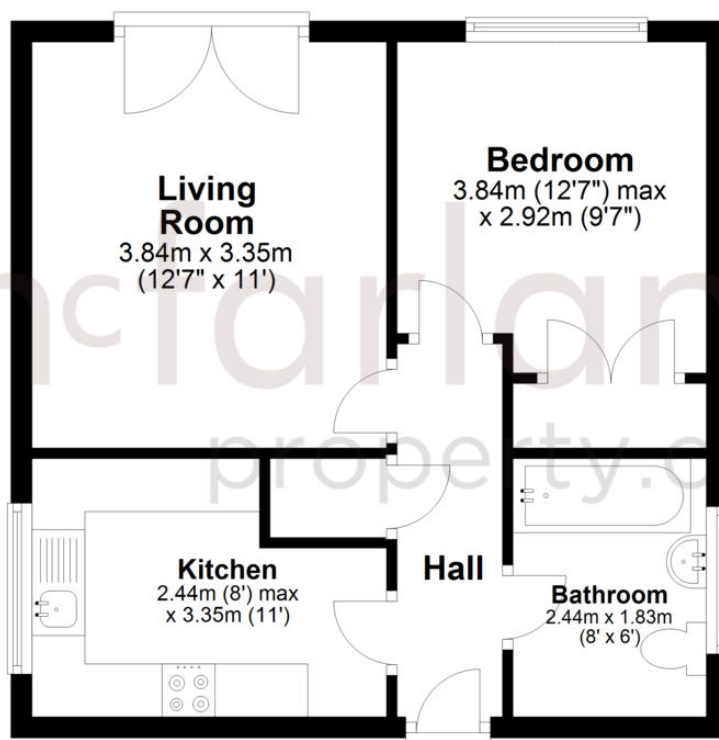

Total area: approx. 40.7 sq. metres (437.7 sq. feet)

We 
where you
LIVE

Our team are friendly, experienced and are all local. They know it better than they do their own living rooms and can help you find what you're looking for because **we love where we live.**

We would be delighted to show you around this property.

**Because every home
needs a personal touch.**

**If you would like to view this
property then please get in touch.**

 01793 296880

 oldtown@mcfarlaneproperty.com

mcfarlaneproperty.com

mcfarlane
property.com

Cricklade.

102 High Street
Cricklade SN6 6AA

 01793 751044

Marlborough.

106 High Street
Marlborough SN8 1LT

 01672 514380

Old Town.

28-30 Wood Street
Swindon SN1 4AB

 01793 296880

Swindon.

The Village Centre,
Redhouse SN25 2FW

 01793 296600

Agents Note: Whilst every care has been taken to prepare these sales particulars, they are for guidance purposes only. All measurements are approximate and are for general guidance purposes only and whilst every care has been taken to ensure their accuracy, they should not be relied upon and potential buyers are advised to recheck the measurements