



2 Bedroom Ground Floor Apartment £155,000

8 Staldon Court, Swindon, SN1 7BY

mcfarlane
property.com

2 Bedroom Ground Floor Apartment Swindon, East Wichel

- NO ONWARD CHAIN
 - OPEN PLAN LIVING
 - EAST WICHEL LOCATION
 - ALLOCATED PARKING
 - TWO BEDROOMS
 - AMPLE NATURAL LIGHT
 - GROUND FLOOR APARTMENT
-



Property description

McFarlane Sales & Lettings are delighted to welcome to market this immaculate two-bedroom ground-floor apartment in East Wichel, available with no onward chain. The property features an inviting entrance hall, spacious open-plan living area, two well-appointed bedrooms, a modern family bathroom, and a convenient storage cupboard. The annual service charge and ground rent for the property is £1,200. Additionally, the apartment includes allocated parking. Ideally situated close to Junction 16 and within easy reach of local amenities, including schools and shops, this home is perfect for first-time buyers or as a smart investment opportunity.



Ground Floor

Approx. 51.4 sq. metres (553.7 sq. feet)

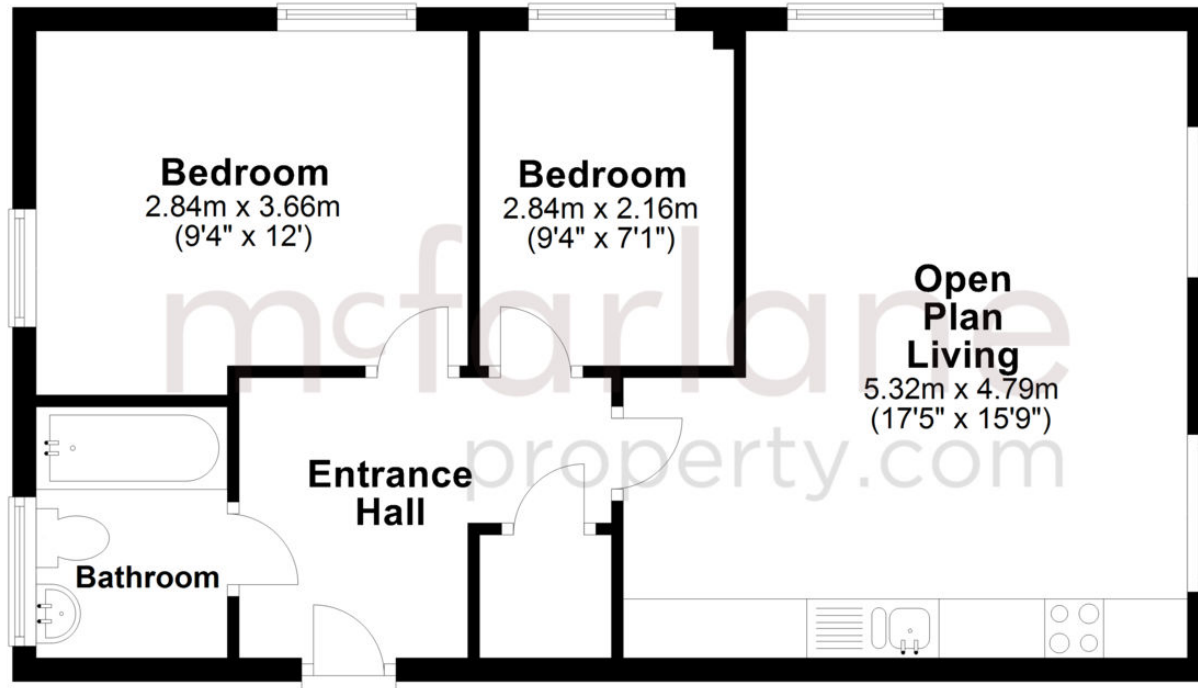

Total area: approx. 51.4 sq. metres (553.7 sq. feet)

We 
where you
LIVE

Our team are friendly, experienced and are all local. They know it better than they do their own living rooms and can help you find what you're looking for because **we love where we live.**

We would be delighted to show you around this property.

**Because every home
needs a personal touch.**

**If you would like to view this
property then please get in touch.**

📞 01793 296880

✉️ oldtown@mcfarlaneproperty.com

mcfarlaneproperty.com

mcfarlane
property.com

Cricklade.

102 High Street
Cricklade SN6 6AA

📞 01793 751044

Marlborough.

106 High Street
Marlborough SN8 1LT

📞 01672 514380

Old Town.

28-30 Wood Street
Swindon SN1 4AB

📞 01793 296880

Swindon.

The Village Centre,
Redhouse SN25 2FW

📞 01793 296600

Agents Note: Whilst every care has been taken to prepare these sales particulars, they are for guidance purposes only. All measurements are approximate and are for general guidance purposes only and whilst every care has been taken to ensure their accuracy, they should not be relied upon and potential buyers are advised to recheck the measurements